

Part number

MHPW 48 LS40



Surface mounting housing, W-TYPE series, with 1 lever, M40 cable entry, size "104.62", with metal cover

Product description

Product type	Surface mounting housing
Series	W-TYPE
Closing type	With 1 lever
Size	Size "104.62"
Cable entry	M40
Specification	With metal cover

Technical data

IP degree of protection	IP65 / IP66 / IP69
--------------------------------	--------------------

Further technical details

Weight	2,50 g
Operating temperature range (min, max)	-40°C...+125°C

Material properties

Colour	RAL 9005 black
RoHs conformity	Compliant
China RoHs - EFUP	E
REACH SVHC substances	No

Approvals / Standards

Certifications	DNV, BV
UL	ECBT2
cUL	ECBT8

General ordering information

EAN13 code	8015747152716
eCl@ss 8.1	27440202
ETIM 7.0	EC000437

Packaging Information

Packaging length	305,00 mm
Packaging height	180,00 mm
Packaging width	275,00 mm
Packaging volume	15,10 dm ³
Packaging description	Carton box
Packaging quantity	4 Pcs
Packaging EAN code	8015747208758
Sub-packaging description	Plastic packaging
Sub-packaging quantity	1 Pcs
Sub-packaging EAN barcode	8015747208765

Part number

MHPW 48 LS40



Catalogue drawings

CHIWL S

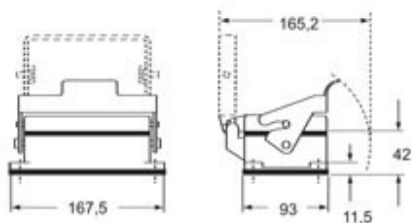

CHPW LS MHPW LS

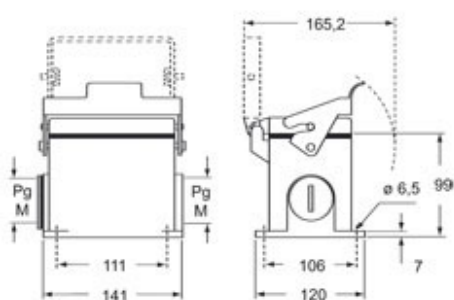

Notes

Dimensions shown in mm are not binding and may be changed without notice.